

This plan has been drafted by PLANW3ST, an independent, experienced CPTED consultant.

It is understood that SAFETY AND SECURITY REVIEWS do not guarantee a crime will never occur; it is an effort to mitigate opportunities for crime and to help avoid any present and future security deficiencies, conflicts, threats, breaches, or liabilities that might occur without any review. It is further understood that all comments made by the Broward Sheriff's Office regarding this plan are preliminary only, as additional SECURITY STRENGTHENING AND CPTED attributes may be required as development progresses.

PROPOSED CAMERA AND MONITORING LOCATIONS WILL BE COORDINATED WITH A SECURITY AND ACCESS CONTROL CONSULTANT AS WELL AS THE BROWARD SHERIFF'S OFFICE CPTED REVIEWER *** PRIOR *** TO PERMITTING. PLANNING AND INSTALLATION OF THE SURVEILLANCE MONITORING SYSTEM MUST INCLUDE FIELD INPUT FROM EXPERIENCED CPTED / SECURITY STRENGTHENING LAW-ENFORCEMENT TO ENSURE OPTIMAL RESULTS.

When a Broward Sheriff's Office CPTED Practitioner is required to assist in an inspection of the project during the Certificate of Completion &/or Certificate of Occupancy Application Phase, Security Strengthening & CPTED measures that have not been adequately addressed will still be required to ensure the safety & wellbeing of the employees, residents, tenants, visitors & all legitimate users of the site.

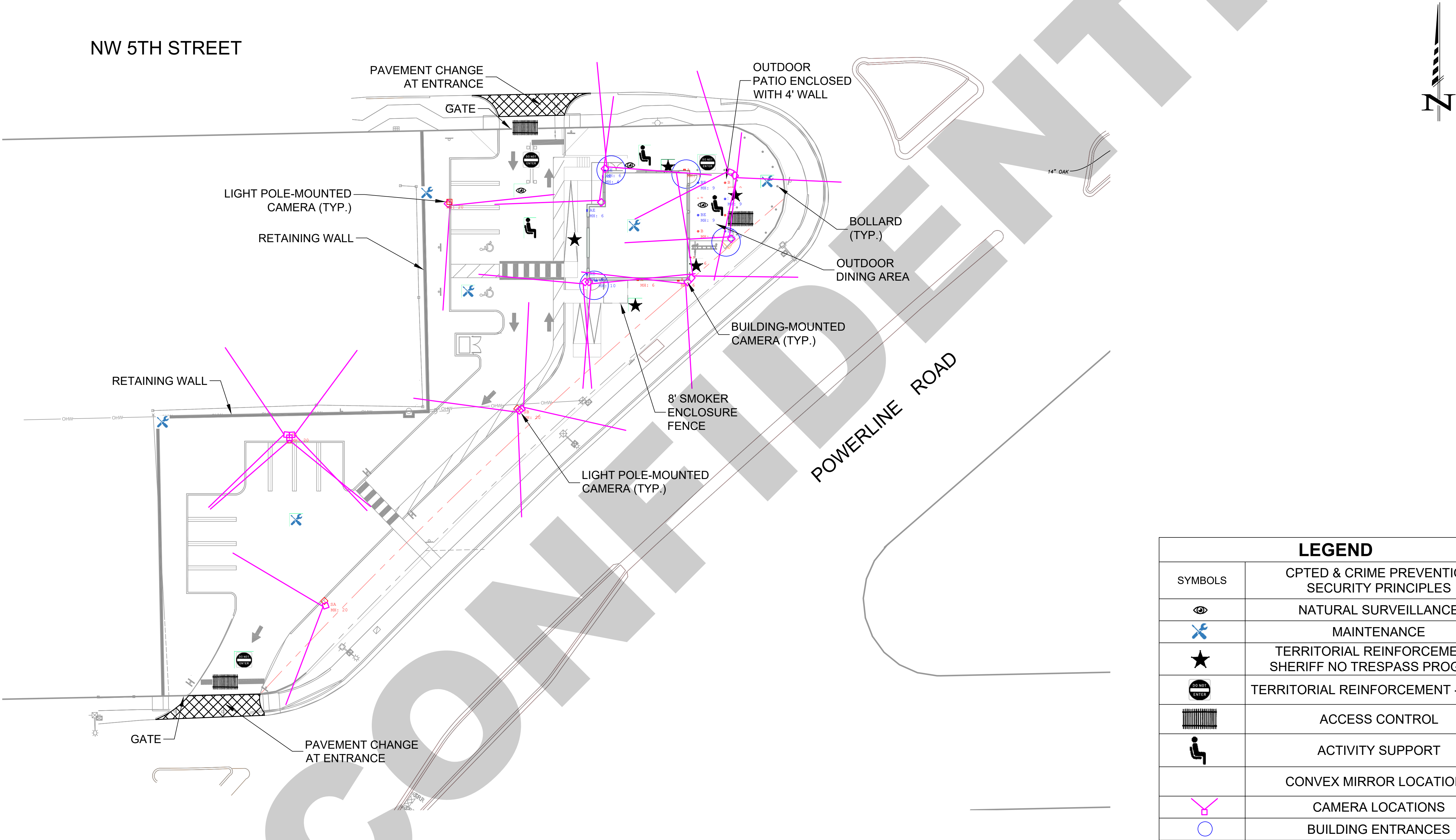

PUBLIC SAFETY SECURITY (CPTED) SITE PLAN

General Notes

3	DRC RESUBMITTAL	10/27/2025
2	DRC SUBMITTAL	8/25/2025
1	PRE-APP SUBMITTAL	4/17/2025
No.	Revision/Issue	Date

PLANW3ST
10152 INDIANTOWN RD.
159
JUPITER, FL 33478
954-529-9417
planw3st.com

Project Name and Address

BIG TREE BBQ
N POWERLINE RD
POMPAÑO BEACH FL 33069

Project	2023-051	Sheet	PS-1 AAC
Date	4/17/2025		
Scale	1" = 20'		

PZ25- 12000012
02/03/2026